

(4) DOORS
 16 3/8 83 Mel Slab White Mel

PANEL STOCK
 (1) 3 1/16 64 1/2 Valance Mel White
 (1) 20 64 1/2 Head Board Mel White
 (1) 3 1/16 64 1/2 Head Board Valance Mel White
 (1) 20 90 Finished Left End Mel White
 (1) 20 90 Finished Right End Mel White
 (1) 4 1/16 64 1/2 Front Toe Mel White
 (1) 20 64 1/2 Top Mel White

HARDWARE
 (8) 1 2 1/2 Std Hinge Salice 165
 (2) 1/4 4 Door Pull None Selected

CABINET # 1 - Q4MB QUEEN MURPHYBED

66 x 90 x 20 (1)

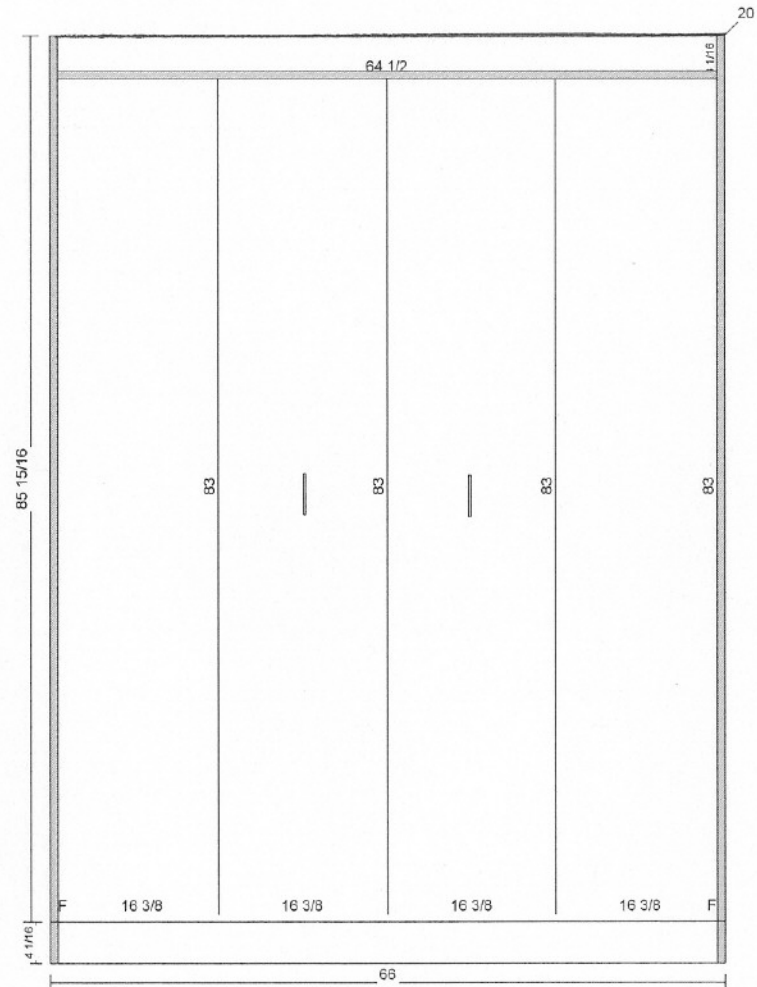

CABINET # 1 - Q4MB QUEEN MURPHYBED

L.Reveal = 1/16 R.Reveal = 1/16 T.Reveal = 0 B.Reveal = 1/2
 H.Reveal = 1/8 V.Reveal = 1/8
 Left End = Finished Right End = Finished Back = Unfinished
 Toe Height = 4 1/16 Toe Recess = 0

Architectural Cabinetry

www.panelbed.com

This is not exact information, some items may vary

Room # 1 (Room 1) - Wall # 1

Date : 08-22-2003

DOORS				
(4)	16 3/8	52 3/4	Mel Slab	White Mel
(4)	16 3/8	30 1/16	Mel Slab	White Mel

PANEL STOCK				
(1)	3 1/16	64 1/2	Valance	Mel White
(1)	20	64 1/2	Head Board	Mel White
(1)	3 1/16	64 1/2	Head Board Valance	Mel White
(1)	20	90	Finished Left End	Mel White
(1)	20	90	Finished Right End	Mel White
(1)	4 1/16	64 1/2	Front Toe	Mel White
(1)	20	64 1/2	Top	Mel White

HARDWARE				
(8)	1	2 1/2	Std Hinge	Salice 165
(2)	1/4	4	Door Pull	None Selected

CABINET # 1 - Q8MB QUEEN MURPHYBED

66 x 90 x 20 (1)

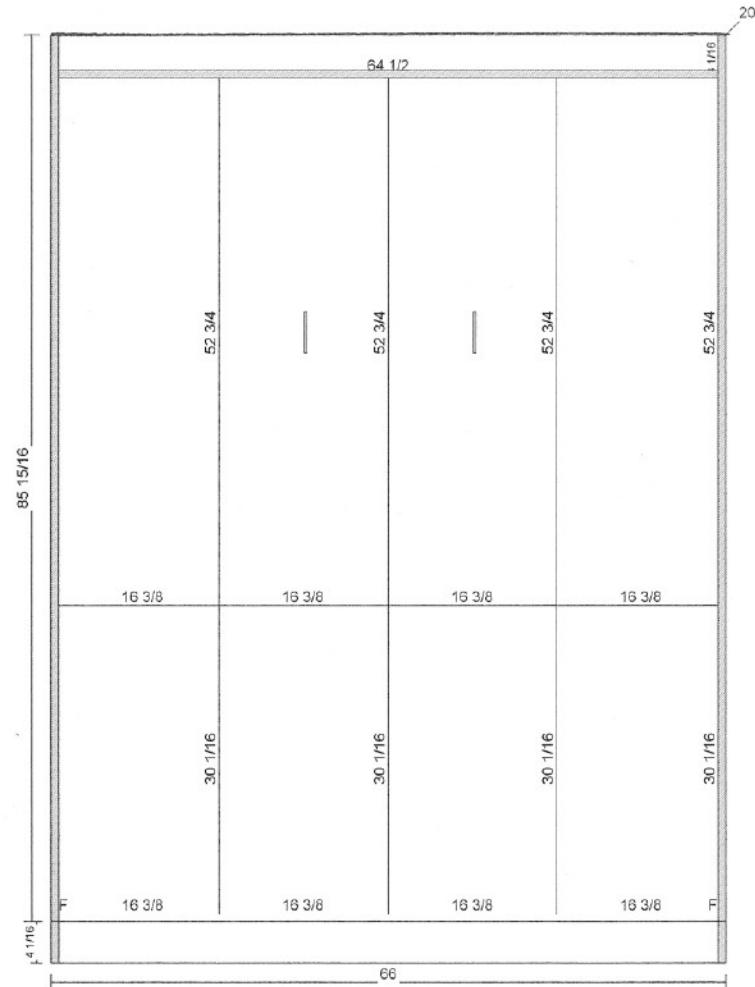

CABINET # 1 - Q8MB QUEEN MURPHYBED

L.Reveal = 1/16	R.Reveal = 1/16	T.Reveal = 0	B.Reveal = 1/2
Left End = Finished	Right End = Finished	H.Reveal = 1/8	V.Reveal = 1/8
Toe Height = 4 1/16	Toe Recess = 0	Back = Unfinished	

Architectural Cabinetry

www.panelbed.com

This is not exact information, some items may vary

Room # 1 (Room 1) - Wall # 1

Date : 08-22-2003